

21/01696/FUL – Pittville Student Village, Albert Road

Proposals:

Temporary dual use of up to 205 bedrooms for either student accommodation (C1) or serviced apartment accommodation (C1) for an 18 month period commencing June 2023

Update report following the Planning Committee's resolution to grant planning permission (subject to variation of the s106 Agreements) in November 2021. A significant delay in the completion of the Deed of Variation of the original s106 Agreement has prevented the issuing of the decision.

Revised proposed commencement date – June 2023

No other alterations to the previous proposals or changes in the use or activities on site.

Site Location Plan

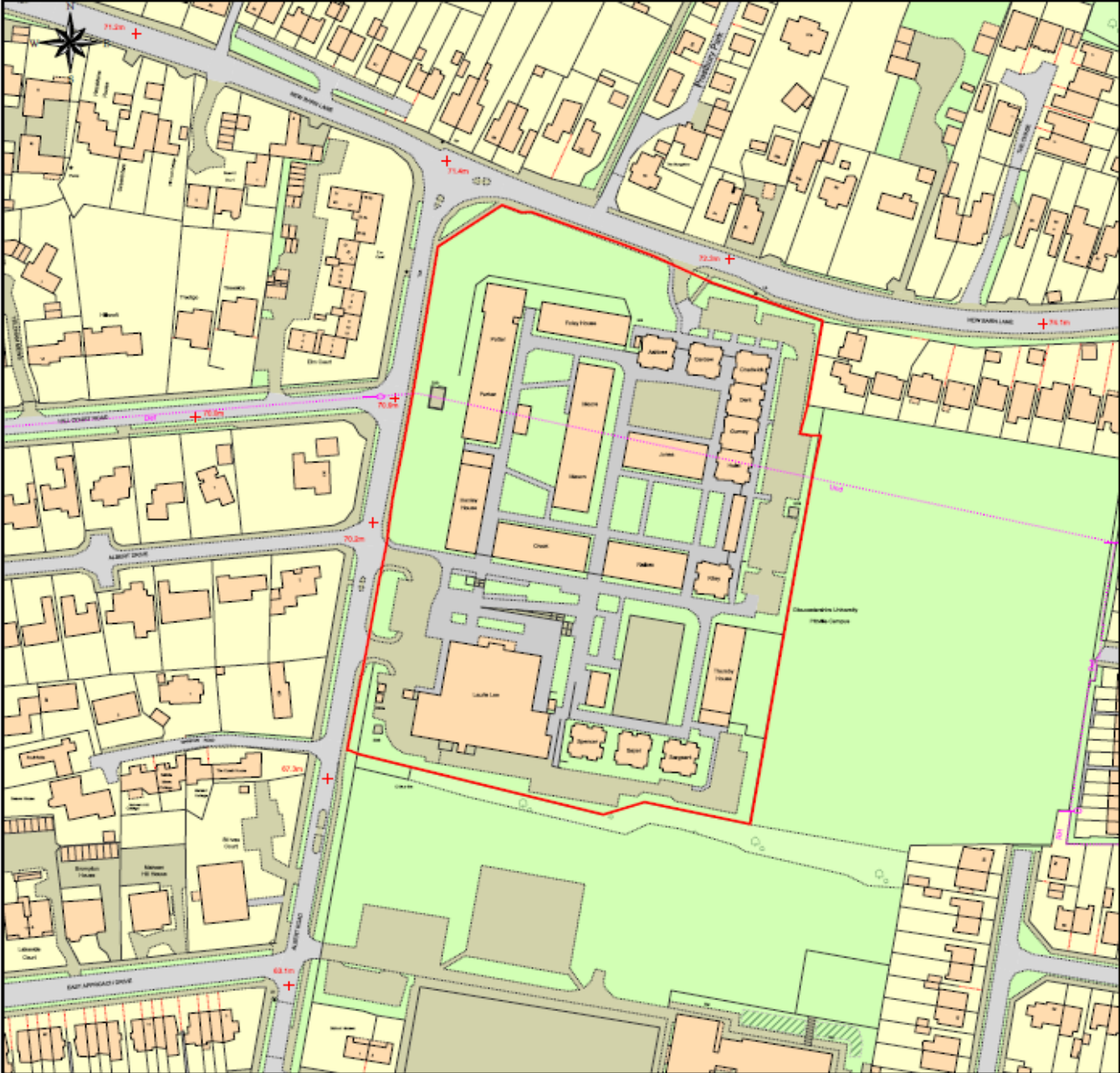

This Plan includes the following Licensed Data: OS MasterMap Colour PDF Location Plan by the Ordnance Survey National Geographic Database and incorporating copyright revision available at the date of production.

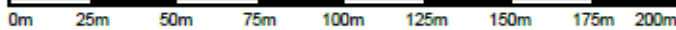

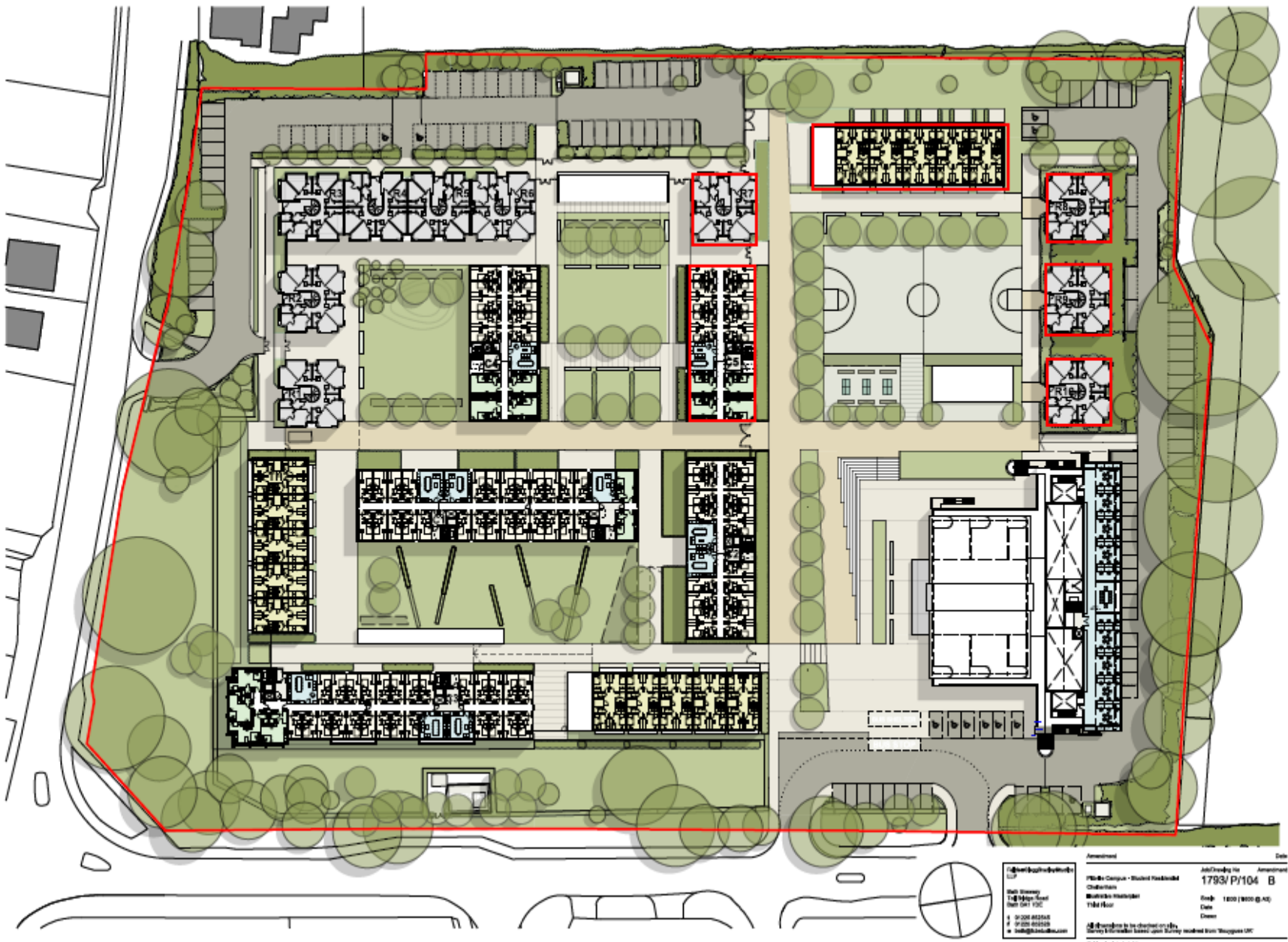

<p>Site Strategy 1.8 Mpa Steel 120' x 120' 10/20/2020 10/20/2020</p>	<p>Amendment 1793/P1104 B 1001 (800) 615 Date Drawn</p>	<p>Amendment 1793/P1104 B 1001 (800) 615 Date Drawn</p>
---	--	--

All drawings to be checked on site.
 Survey information based on survey provided from 'Mapbox US'.
 © 2020 Mapbox et al.

Proposed Block Plan

Key Planning Matters

- Any change in site or neighbourhood characteristics since 2021
- Neighbour amenity
- Parking congestion and highway safety in nearby streets
- Any changes to national and local planning policy and guidance since 2021

Summary of Conditions

Standard conditions and conditions relating to:

- Temporary planning permission ending on 31st December 2024
- Limit of 90 day rental agreements (other than for students and university staff)
- Compliance with applicant's supporting statement
- On-site parking provision for 75 vehicles made available between the hours of 18:00 and 08:00 Monday to Sunday