

BENHALL ROUNDABOUT

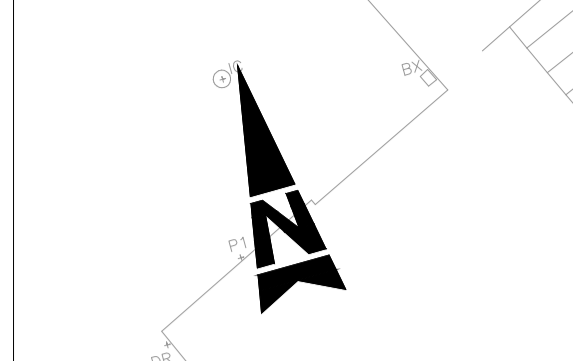

- NOTES:**
1. TRANSPLANTED TREE-LOCATION NEEDS TO BE CONFIRMED ON SITE TO AVOID UNDERGROUND UTILITIES IN AREA.
 2. THE NO-DIG CONSTRUCTION TECHNIQUE REQUIRES THE REMOVAL OF THE TURF LAYER ONLY. THE CYCLEWAY WILL BE CONSTRUCTED ABOVE TREE ROOTS USING PERMEABLE PAVING.

- KEY:**
- VEGETATION
 - GRASS AREA
 - CENTRAL RESERVE
 - EXISTING TREE
 - EXISTING TREES TO BE TRANSPLANTED
 - CARRIAGEWAY
 - PROPOSED FOOTWAY
 - PROPOSED CYCLEWAY
 - SHARED USE PATH
 - PROPOSED SPECIES RICH GRASS TO BUFFER ZONE
 - PROPOSED SHRUBS
 - PROPOSED TREE
 - PROPOSED RAISED CROSSING
 - PROPOSED TACTILE PAVING (UNCONTROLLED CROSSING - BUFF COLOUR)

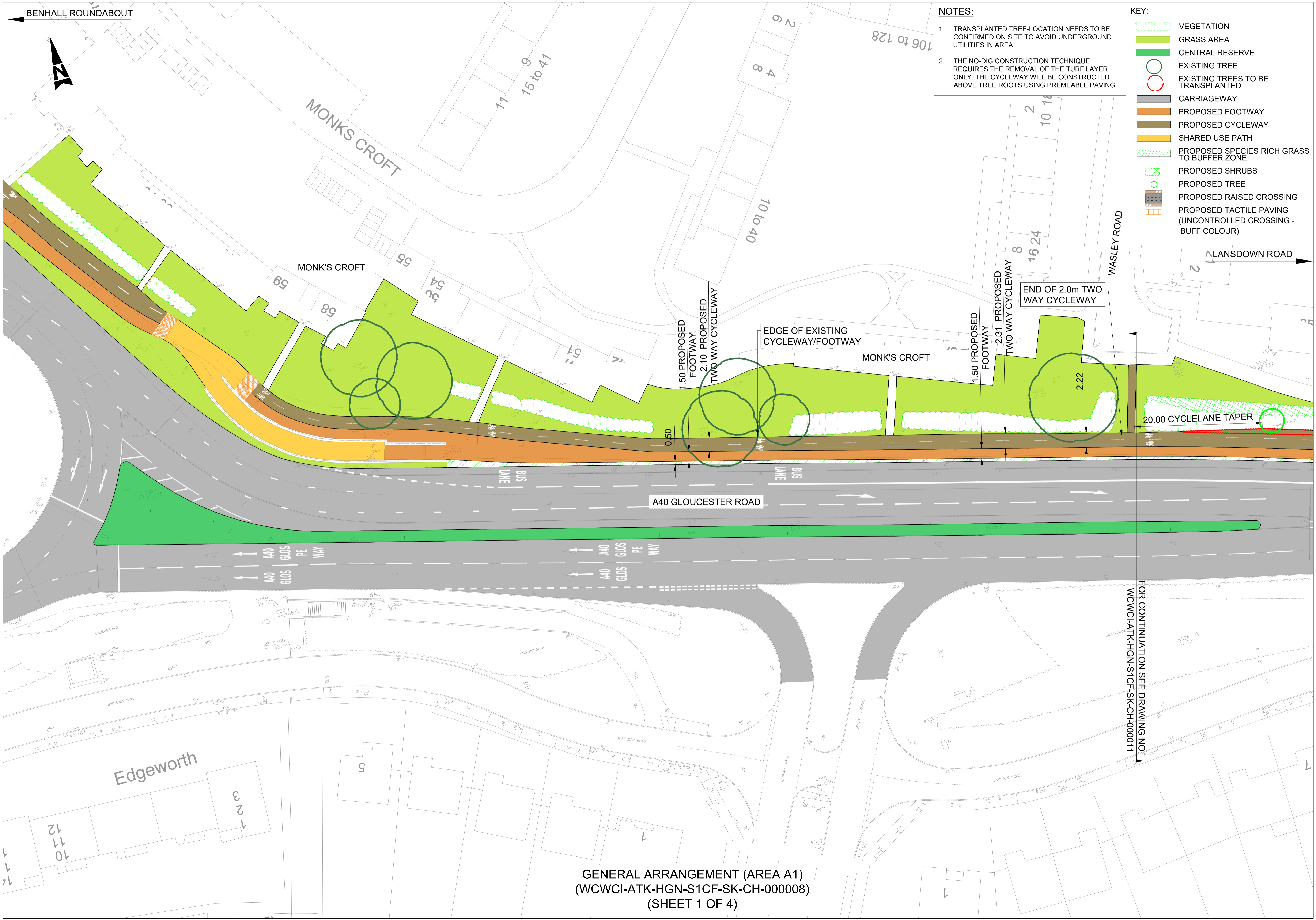

GENERAL ARRANGEMENT (AREA A1)
 (WCWCI-ATK-HGN-S1CF-SK-CH-000008)
 (SHEET 1 OF 4)

FOR CONTINUATION SEE DRAWING NO. WCWCI-ATK-HGN-S1CF-SK-CH-000011